

CASIO Electronic Dictionary Quick Guide (XD-A Series)

The contents of this Quick Guide apply to the CASIO XD-A Series Electronic Dictionaries. Most illustrations and screen shots show the XD-A8500.

- Hangul, Russian, Simplified Chinese, and accented characters cannot be input on a model that does not include a dictionary that requires such characters. Input of the applicable characters becomes possible when optional software is installed.

Loading Batteries for the First Time

Load the two AA-size batteries that come with the electronic dictionary before trying to use it.

- 1 Remove the battery cover. Pressing at the two points shown in the illustration, slide the cover in the direction indicated by the arrows.
- 2 Load two batteries. Push against the spring with the (-) end of a battery. With the battery on top of the ribbon, press the (+) end down. Make sure the (+) and (-) ends are facing correctly and that the springs are pressed straight down.

- 3 Replace the battery cover. Press the (+) end of a battery down.
- 4 Remove the stylus from the side of the electronic dictionary and then press the RESET button on the bottom. Do not use a toothpick, lead pencil, or other breakable object.

- 5 Unfold the electronic dictionary. Lift the top cover of the dictionary.

- 6 On the "Handwriting Panel Contrast Adjustment" screen, use left and right arrows to adjust handwriting panel contrast. Then press [Enter/Select]. If the message "表示 (メインまたは手書き) 保護フィルムが..." (Display (the main display or handwriting panel) protective film may be on the display. Please remove it.) appears, remove the protective film from the main display and/or handwriting panel.

- 7 On the "Battery Settings" screen, confirm that "アルカリ電池" (Alkaline Batteries) is selected as the battery type.

- If you have commercially available eneloop batteries or rechargeable EVOLTA batteries loaded, use down and up arrows to select the battery type and then press [Enter/Select] (Translate/Select).
 - If you have commercially available EVOLTA alkaline batteries loaded, select "アルカリ電池" (Alkaline batteries).
- 8 Press [Enter/Select] to display the MENU screen. If the "本機はユーザー名を登録することができます..." (You can register a user name for this dictionary...) message appears instead of the "メニュー" screen, press [Enter/Select].

Turning Power On and Off

Power turns on and off automatically whenever you open or close the electronic dictionary's panels.

- You also can use the following key operation to turn power on or off.

- 1 Press the [Power] key to turn on power. Power also turns on when you press a dictionary/mode key.
- 2 Press [Power] again to turn off power.

General Guide

Handwriting panel Use this panel to hand-write characters for input. Also, touching buttons that appear here performs certain operations.

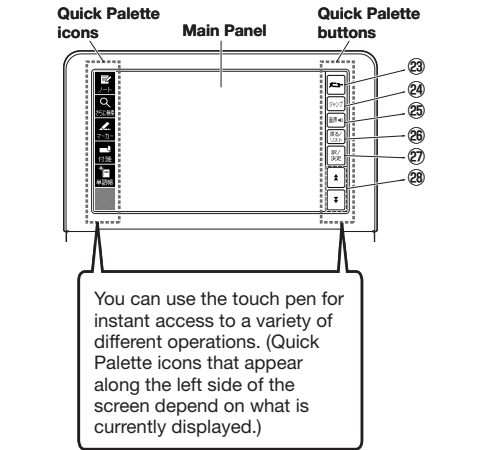
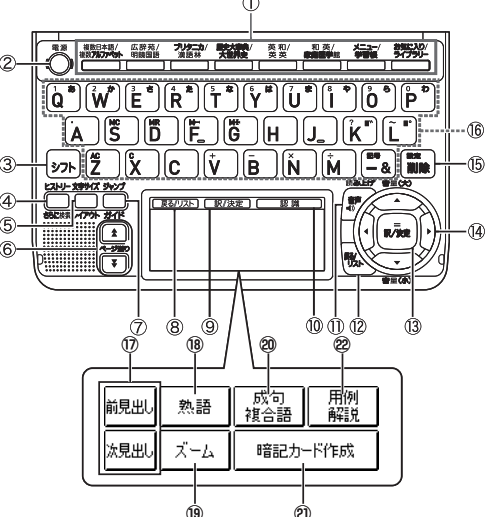

You can use the touch pen for instant access to a variety of different operations. (Quick Palette icons that appear along the left side of the screen depend on what is currently displayed.)

- 1 [Dictionary/mode keys] Toggle between the initial screens of the two dictionaries/modes assigned to each key.
- 2 [Power] Key Toggles power on and off.
- 3 [Shift] Key Shifts the keyboard. To use [Shift], press and release it and then press the next key.
- 4 [History] Key (Additional Search) Key Accesses history data. Press after [Shift] to perform additional search (さらに検索).
- 5 [Text Size] Key Cycles through available screen text sizes. Press after [Shift] to change the screen layout.
- 6 [Scroll] Keys Scroll screen contents up and down. Press after [Shift] to jump back or forward between terms.
- 7 [Jump] Key Enables look up of a term on the currently displayed definition or explanation screen. Press after [Shift] to view guide information.
- 8 [Back/List] Key Performs the same functions as the [Back/List] key.
- 9 [Translate/Select] Key Performs the same functions as the [Translate/Select] key.
- 10 [Confirm] Key Touch after inputting a character when inputting individual characters on the handwriting panel.
- 11 [Audio] Key Press when you want to hear something pronounced by a native speaker. Press after [Shift] to hear a reading by a synthesized voice.
- 12 [Back/List] Key Back-steps through previous operations. Press while a dictionary's initial screen is displayed to return to the "メニュー" screen. Press while a definition screen is on the display to switch to the list of terms, which includes the term whose definition you were viewing.
- 13 [Translate/Select] Key Executes a function or selects an on-screen item.
- 14 Arrow Keys Move the selection highlighting or cursor up, down, left, or right. Used during volume adjustment to raise and lower the volume level.
- 15 [Setup/Delete] Key Deletes the character at the current cursor location. Press after [Shift] to display a screen for changing the setup of the electronic dictionary.
- 16 Letter Keys Enter letters and numbers.
- 17 [前見出し]・[次見出し] Key Jump from the current term to the previous or next term. The same result can be achieved by pressing [Shift] and then [Left] or [Right].
- 18 [熟語] Key Displays compound terms that use the kanji you are currently viewing in the "新漢語林" (Japanese kanji) dictionary.
- 19 [Zoom] Key Enlarges the characters of a definition or explanation screen.
- 20 [成句複合語] Key Displays phrases and compound expressions that use the term you are currently viewing.
- 21 [暗記カード作成] Key Creates a flash card.
- 22 [用例解説] Key Displays examples and explanations in dictionaries that include such information.
- 23 [メニュー] Key Displays the menu screen.
- 24 [ジャンプ] Key Performs the same functions as the [Jump] key.
- 25 [音声] Key Performs the same functions as the [Audio] key.

- 26 [戻る/リスト] Key Performs the same functions as the [Back/List] key.
- 27 [訳/決定] Key Performs the same functions as the [Translate/Select] key.
- 28 [スクロール] Key Performs the same functions as the [Scroll] keys.

Display Indicators

The following explains the meanings of display indicators.

Table with 2 columns: This indicator: and Means this:.

Precautions when Using the Stylus

- When using the stylus to perform operations on the main panel, avoid applying excess pressure. Excess pressure can crack the main panel.
- When using the stylus to perform an operation on the handwriting panel, support the main panel from behind with your hand.

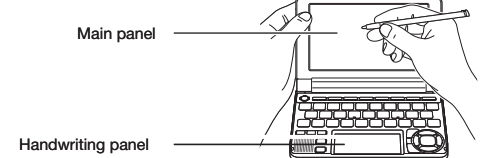

Keyboard Input

Japanese

- Use alphabetic characters to input Japanese.
- Table showing input examples: いんかん, さんぽ, きょう, らっこ, とーるーず

Alphabetic Characters

- Use English input for unaccented alphabetic characters.

Table: To input this: | Type this: | Example: internet | I N T E R N E T

Accented Characters

- All alphabetic characters are input in lower-case, regardless of their normal capitalization.
- For the German "ß", input "ss".
- For other characters that normally include a diacritic, input the character without the diacritic. Example: "à" -> "a", "ê" -> "e", etc.
- For the French "ç" input "c", and for "œ", input "oe".
- Input hyphenated terms as single words, without a hyphen. To look up "peut-être", for example, input "peutetre".
- When inputting a term that consists of multiple words, input the words without any spaces. To look up "magna cum laude", for example, input "magnacumlaude".
- When entering a noun that is normally accompanied by an article, enter the noun only without the article. To look up "die Elbe" for example, input "Elbe".

Hangul



Table: To input this: | Type this: | Example: 박 | [P] [B]

Chinese (Pinyin)



Table: To input this: | Perform this operation: | Example: ü | Type (Keyboard): [V]

Russian



Table: To input this: | Type this: | Example: слабио | [S] [L] [A] [B] [I] [O]

- To input a character marked in the upper right corner of a key, press (and immediately release) [Shift] and then press the key.
- All of the above characters are input in lower-case.

Handwriting Input

- Use the stylus to write characters on the handwriting panel and then touch [Recognize].
- With some search methods, like "新漢語林", you can enter search terms using handwriting input only.

Character Input Mode

The indicators described below appear on the main panel to show the current input mode.

Also note that the handwriting panel changes to two characters per screen or five characters per screen in accordance with the input mode.

Two Characters Per screen

Table of indicators and supported characters (Hiragana, Katakana, Kanji, Simplified Chinese, Hangul). Includes diagram of the two-character handwriting panel.

Five Characters Per screen

Table of indicators and supported characters (Alphabetic, Accented alphabetic, Russian, Numbers). Includes diagram of the five-character handwriting panel.

Correcting Character Input

Example: After mistakenly inputting "喜怒哀楽" instead of "喜怒哀楽", touch [Rewrite] to correct the input.

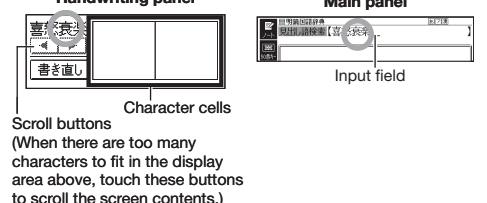

- 1 On the handwriting panel or in the input field on the main panel, touch a character (衰). This displays up to 10 possible candidates for the character.
- 2 If you find the correct character among the candidates, touch it.
- 3 If you do not find the correct character, touch [Rewrite], rewrite the character on the handwriting panel and then touch [Recognize]. Touching [Rewrite] while the character cells of the handwriting panel are blank (nothing input) will delete the character currently in the input field of the main panel.

Stylus Basics

- To select a dictionary: Touch the Quick Palette [Menu] button to display the menu screen. Touch a category and then a dictionary name.

3 Touch the highlighted dictionary name again.

- This displays the initial screen of the dictionary.
- You also could touch the 【訳 / 決定】 (Translate/ Select) Quick Palette or handwriting panel button instead of the dictionary name.

■ To select a headword or screen item

- 1 Enter the characters you want to find. On the list that appears, touch the term or screen item you want.
 - This highlights the term or item.

- 2 Touch the highlighted term or item again.
 - This displays the definition or explanation in the case of a term, or the next screen in the case of a screen item.
 - You also could touch the 【訳 / 決定】 (Translate/ Select) Quick Palette or handwriting panel button instead of the term or item.

Search Functions

There are five basic patterns for term searches.

- 【パターン 1】 (Pattern 1): Entering the first few characters of the term you want to find
 - 【パターン 2】 (Pattern 2): Entering the term you want to find and then pressing 【訳 / 決定】 .
 - 【パターン 3】 (Pattern 3): Searching step-by-step through a series of titles
 - 【パターン 4】 (Pattern 4): Specifying multiple conditions
 - 【パターン 5】 (Pattern 5): Touching a screen item
- For details about the search patterns of each dictionary, see the “収録辞典一覧” (Dictionary List) chapter in the “取扱説明書” (User’s Guide).

【パターン 1】 (Pattern 1): Entering the first few characters of the term you want to find

The displayed list of search results changes as you enter characters of the term you want to find. Example: To look up the meaning of “fine” (ジーニアス英和辞典)

- 1 Use ▲ and ▼ to select “見出し語検索” (Headword Search).
- 2 Enter the term you want.
 - As you enter each character, the list of terms on the main panel is updated accordingly.
 - When entering a headword, you can use the following wildcard characters.

Character	Represents
?	A single unknown character
~	A series of multiple unknown characters of unknown length

- 3 Use ▲ and ▼ to move the highlighting to a term and then press 【訳 / 決定】 to display its definition screen.

【パターン 2】 (Pattern 2): Entering a term and then pressing 【訳 / 決定】

Enter the entire term you want to find and then press 【訳 / 決定】 . Example: To find the phrases that use the words “get” and “to” (ジーニアス英和辞典)

- 1 Use ▲ and ▼ to select “成句検索” (Phrase Search).
 - Select “例文検索” (Example Search) to search for an example.
- 2 Enter the term.
 - When inputting multiple words, separate them using the ampersand character (&), not spaces. Example: get to → get&to
- 3 Press 【訳 / 決定】 .
 - This displays a list of all phrases that contain the terms.

- 4 Use ▲ and ▼ to move the highlighting to a phrase and then press 【訳 / 決定】 to display detailed information.

【パターン 3】 (Pattern 3): Searching step-by-step through a series of titles

With some dictionaries, you simply select successive screen items and settings until you arrive at the information you need. Example: To look up an English conversation expression (英会話とっさのひとこと辞典)

After displaying the initial “英会話とっさのひとこと辞典” screen, select the following: “[A] 場面から探す” (Search by circumstance) → “[A] 毎日の生活でつかうひとこと” (Daily life expressions) → “[A] 家のなかで” (At home) → “[A] 起きてから出かけるまで” (Morning). This will bring you to a screen that displays the English expression for the Japanese “おはよう” (Good morning).

【パターン 4】 (Pattern 4): Specifying multiple conditions

With this type of search, you can input multiple keywords, terms, or other conditions. Example: To look up “志” (新漢語林 / Japanese Kanji Dictionary)

- The kanji “志” has the radical “心” (heart), and a total of 7 strokes. This information can be used to look up the kanji.

- 1 Select “ 単漢字を読み/画数から探す” (Single Kanji Reading/Number of Stroke Search) and then press 【訳 / 決定】 .
 - If a selection item has a letter at the beginning, you can press the corresponding letter key to execute the selection directly. In case of the above, for example, you could simply press .

- 2 Use ▲, ▼, ◀ and ▶ to move the highlighting to the “部首読み” (Radical Reading) column, enter “こころ” (heart), and then press 【訳 / 決定】 .
 - This displays a list of applicable radicals.

- 3 Use ▲, ▼, ◀ and ▶ to select “心” and then press 【訳 / 決定】 .

- 4 Use ▲, ▼, ◀ and ▶ to move the highlighting to “総画数” (Total Strokes) and then enter 7.
 - Use the top row of keyboard keys to enter numbers.

- 5 Press 【訳 / 決定】 .
 - This displays a list of kanji characters that satisfy the conditions.

- 6 Use ▲, ▼, ◀ and ▶ to select “志” and then press 【訳 / 決定】 .
 - This displays an explanation of the term.

【パターン 5】 (Pattern 5): Touching a screen item

You can perform a search simply by touching some screen items on the main panel screen with the stylus. Example: To look up “十勝岳” (百科事典マイペディア)

After displaying the “百科事典マイペディア” initial screen, touch “地図から検索” (Map Search) twice, and then touch “日本地図から山を検索” (Search for Mountains in Japan Maps) twice → “北海道” (Hokkaido) → “十勝岳” (Tokachidake) to display a screen that explains about “十勝岳” (Tokachidake).

Other Searches

Jump Search

You can use jump search to jump to another location in the same dictionary or to another dictionary.

■ To jump within the same dictionary

- 1 When search results show items with a large arrow (⇨) or small arrow (⇩) jump symbol, press .
 - The indicator appears and the first character on the screen becomes highlighted.

- 2 Use the arrow keys to move the highlighting to an item to the right of a jump symbol (⇨ or ⇩) and then press 【訳 / 決定】 to jump.
 - Instead of the above procedure, you also can perform the jump by touching the term to the right of the arrow symbol.

■ To jump to another dictionary

- 1 While the results of a search are displayed, press .
 - The indicator appears and the first character on the screen becomes highlighted.

- 2 After using the arrow keys to move the highlighting to the term you want to look up, touch the handwriting panel 【選択】 (Select) button or the Quick Palette 【選択】 icon.
 - This displays a dictionary menu.
 - Instead of the arrow keys, you also could use the stylus to touch the term to which you want to jump and then touch 【訳 / 決定】 .

- 3 Use ▲ and ▼ to select a dictionary and then press 【訳 / 決定】 .
 - This displays a list of candidates.

- 4 Use ▲ and ▼ to move the highlighting to the item you want and then press 【訳 / 決定】 to jump.

■ To use the mini dictionary to look up a term

- 1 While a search result screen is displayed, press (Jump).
 - The indicator appears and the first character on the screen becomes highlighted.

- 2 After using the arrow keys to move the highlighting to the term you want to look up, touch the handwriting panel 【ミニ辞書】 (Mini Dictionary) button or Quick Palette 【ミニ辞書】 (Mini Dictionary) icon.
 - To close the Mini Dictionary, press (Back/List).

Multi-dictionary Search

Use the following procedure to search for a term across multiple dictionaries.

- 1 On the “メニュー” screen, select the 便利な機能 (Useful Functions) tab and then select “複数辞書アルファベットで検索” (Alphabetic Multi-dictionary Search).
 - You also could select “複数辞書日本語で検索” (Japanese Multi-dictionary Search).

- 2 Use ▲ and ▼ to select “アルファベットで検索” (Search using alphabetic characters).
 - If you are performing the Japanese Multi-dictionary Search, select “ひらがなで検索” (Search using hiragana).

- 3 On the search screen that appears, enter a term.
 - Terms starting with the characters you have entered appear in a list on the display.
 - Each term also includes an indicator showing its dictionary.

- 4 Use ▲ and ▼ to move the highlighting to a dictionary and term combination and then press 【訳 / 決定】 .

Useful Functions

Powerful features and functions help make dictionary look ups quicker and easier.

Viewing Phrases and Compound Expressions

成 複 or 成 句 indicates there is phrase and compound expression information available. On the handwriting panel, touch 【成句複合語】 to display it. On the main panel, touch the phrase or compound expression you want to view and then touch 【訳 / 決定】 on the handwriting panel. This will display the meaning of the phrase or compound expression that you selected.

On the main panel, touch the phrase or compound expression you want to view and then touch 【訳 / 決定】 on the handwriting panel. This will display the meaning of the phrase or compound expression that you selected.

Viewing Compound Terms

熟 語 indicates there is compound term information available. On the handwriting panel, touch 【熟語】 to display it. On the main panel, touch the compound term you want to view and then touch 【訳 / 決定】 on the handwriting panel. This will display the meaning of the compound term that you selected.

On the main panel, touch the compound term you want to view and then touch 【訳 / 決定】 on the handwriting panel. This will display the meaning of the compound term that you selected.

Viewing Examples or Explanations

用 例 or 解 説 indicates there is example information or an explanation available. On the handwriting panel, touch 【用例解説】 to display it. Use the arrow keys to move the highlighting to the icon you want to view and then touch 【訳 / 決定】 on the handwriting panel. This will display the example or explanation.

Pronunciation

Your electronic dictionary can produce native speaker pronunciations and simulated voice readings of terms and examples.

- To use the built-in speaker
 - On the side of the electronic dictionary, slide the pronunciation output switch to SPEAKER.

■ To use earphones

- 1 Connect the supplied earphones to the terminal on the left side of the electronic dictionary.
 - Use only the supplied earphones.

- 2 On the side of the electronic dictionary, slide the pronunciation output switch to PHONES.

■ To adjust the volume

- 1 While any screen is displayed, press .
 - While audio output is in progress, you can adjust its volume by pressing ▲ or ▼ .

- 2 Use the “音量 (大)” ▲ (increase volume) and “音量 (小)” ▼ (decrease volume) arrow keys to adjust the volume level.

- 3 Press 【訳 / 決定】 .
 - While audio output is in progress, you can adjust its volume by pressing ▲ or ▼ .

Using TRUE VOICE® for Native Speaker Pronunciation

TRUE VOICE® capabilities let you hear native speaker pronunciations of terms and examples.

Playing TRUE VOICE® Pronunciation while a Definition Screen is Displayed

Use the following steps to listen to a TRUE VOICE® pronunciation of an item that has a icon next to it.

- 1 Press .
 - The icon becomes highlighted and appears on the display.

- 2 Press 【訳 / 決定】 .
 - This plays the pronunciation of the item next to or below the highlighted icon.
 - If there are multiple icons, use ▲ and ▼ to select one.
 - Instead of the above procedure, you also can play the pronunciation by touching the icon.

- 3 After you are finished using TRUE VOICE®, press so disappears from the display.

Playing TRUE VOICE® Pronunciation while an English Term is Displayed

Use the following steps to listen to a TRUE VOICE® pronunciation of an English term.

- 1 Press .
 - and appear on the display.

- 2 Use the arrow keys to move the highlighting to an English term.
 - Instead of using the arrow keys, you also can highlight the English term by touching it with the stylus.

- 3 Press 【訳 / 決定】 .
 - If there is only one pronunciation, it plays immediately.
 - If there are multiple pronunciations, a list of candidates appears. If this happens, move the highlighting to the term whose pronunciation you want to hear and then press 【訳 / 決定】 .
 - If native speaker pronunciation is not available, a message appears asking if you want to hear a simulated voice reading.

- 4 After you are finished, press .
 - Note that pronunciation may not be correct if a non-English term is selected.
 - Pronunciation may not be correct in cases that two terms have the same spelling but different pronunciations.

Synthesized Voice Readings

A synthesized voice can be used to check the readings of terms in seven languages: English, Spanish, German, French, Italian, Chinese, and Korean.

- Some dictionaries/modes do not support synthetic voice readings.
- Chinese reading can be selected for a Chinese model electronic dictionary and Korean for a Korean model electronic dictionary only. For other models, these languages can be selected after the applicable optional software is installed.
- For Chinese, pinyin and alphabetic terms, and some kanji terms cannot be read by the synthetic voice.
- For Korean, only hangul terms can be read.

■ To play readings on a definition and explanation screen

- 1 Press and then .
 - appears and the first term or example that can be read by the synthesized voice becomes highlighted on the display.

- 2 Use ▲ and ▼ to move the highlighting to the term, phrase, or example you want to have read.
 - Instead of using the arrow keys, you also can highlight the term, phrase, or example by touching it with the stylus.

- 3 Press 【訳 / 決定】 to produce the reading of the term or example.

- 4 After you are finished, press .

Configuring Audio Settings

Use the procedures below to configure audio settings.

■ To display the “音声設定” (Audio Settings) Screen

- 1 Press and then .
- 2 Use the arrow keys to select “音声設定” and then press 【訳 / 決定】 .
 - This displays the settings screen. Use ▲ and ▼ to select the setting you want to change and then press 【訳 / 決定】 . This will display the applicable setting screen.

■ To adjust the reading speed (音声速度設定)

Use ▲ and ▼ to select a speed and then press 【訳 / 決定】 .

- You can set one of five speeds: Approximately 130%, 120%, 100%, 85%, or 75% of normal speed.

■ To specify the pronunciation language (音声言語設定)

Use the arrow keys to select a language setting and then press 【訳 / 決定】 .

- This will change the pronunciation setting of only the dictionary that was selected when you performed the procedure under “To display the 音声設定 (Audio Settings) Screen” .

■ To adjust the reading volume level (音量設定)

Use ▲ and ▼ to select a volume level and then press 【訳 / 決定】 .

- eneloop is a registered trademark of SANYO Electric Co., Ltd.
- EVOLTA is a registered trademark of Panasonic Corporation.